



SETUP SHEET



TRACK CONDITIONS

Type :  Carpet  Asphalt  
 Place :  Indoor  Outdoor  
 Surface :  Smooth  Med.  Bumpy  
 Size:  Open  Med.  Tight  
 Traction:  High  Med.  Low  
 Track Temp/Air Temp: \_\_\_\_\_ / \_\_\_\_\_ 25  
 Note: \_\_\_\_\_

FRONT SUSPENSION

Track Width: \_\_\_\_\_ mm  Gear Diff \_\_\_\_\_ wt  
 Toe Angle: \_\_\_\_\_ 0°  Ball Diff  
 Caster: \_\_\_\_\_ 4°  One Way  
 Camber: \_\_\_\_\_ 1.5°  Solid Axle  
 Ride Height: \_\_\_\_\_ 5 mm Anti-Roll Bar: ∅ \_\_\_\_\_ 1.5 mm  
 Down Stop: \_\_\_\_\_ 5 mm

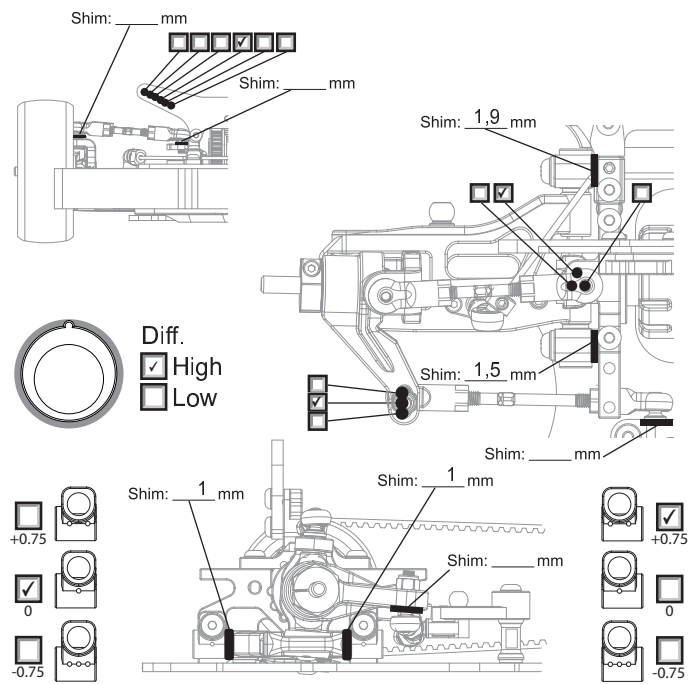

REAR SUSPENSION

Track Width: \_\_\_\_\_ mm  Gear Diff Yok dot 3 wt  
 Toe Angle: \_\_\_\_\_ 2  Ball Diff  
 Camber: \_\_\_\_\_ 1  Solid Axle  
 Ride Height: \_\_\_\_\_ 5 mm  
 Down Stop: \_\_\_\_\_ 4 mm Anti-Roll Bar: ∅ \_\_\_\_\_ 1.3 mm

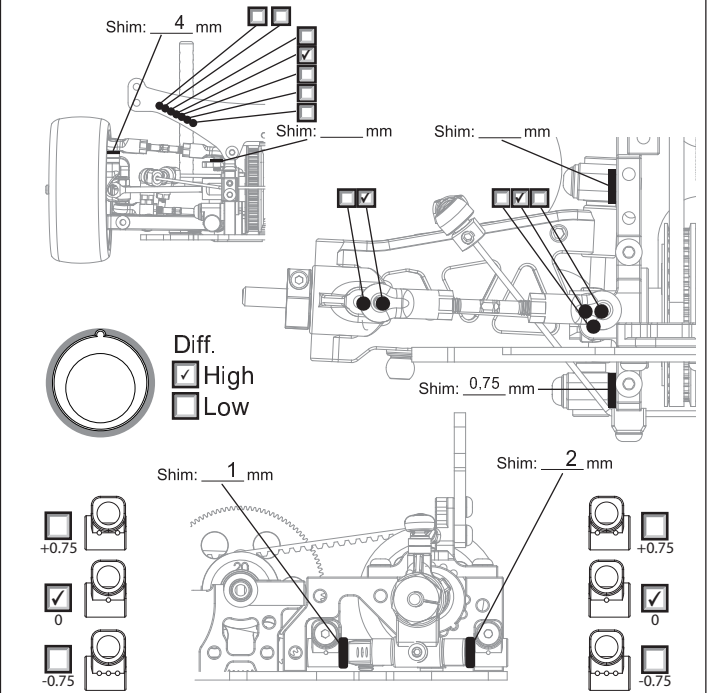

STIFF SETTING



**ELECTRONICS**  
 Servo: Sanwa SRG BL  
 ESC: HW V3  
 Battery: IP 6800

**DRIVE RATIO**  
 Spur 100 T  
 Pinion 40 T  $\times 1.9 = 4.75$

**MOTOR**  
 Brand: Thunder Power  
 Turns: 10.5  
 Timing: 45°

**TIRES**  
 Insert: \_\_\_\_\_  
 Wheel: \_\_\_\_\_  
 Shore/deg: Ride 36  
 Compound: \_\_\_\_\_  
 Tire Temp: \_\_\_\_\_  
 Tire additive: Green RC

**SHOCKS**

Hole Size: F stock \_\_\_\_\_ R stock \_\_\_\_\_  
 Holes In Piston: F 2 \_\_\_\_\_ R 2 \_\_\_\_\_  
 Oil wt: F 500 \_\_\_\_\_ R 500 \_\_\_\_\_  
 Springs: F TOP 289 \_\_\_\_\_ R TOP 289 \_\_\_\_\_  
 Rebound: F 20 \_\_\_\_\_ R 20 \_\_\_\_\_  
 Bladder Note: \_\_\_\_\_  
 Thread Length: F \_\_\_\_\_ R \_\_\_\_\_

**ESC**  
 Punch: \_\_\_\_\_  
 Initial Brake: \_\_\_\_\_  
 Drag Brake: \_\_\_\_\_  
 ESC Timing  Turbo Timing

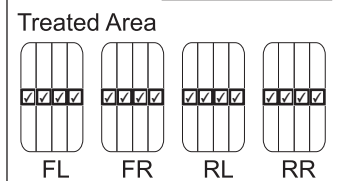

**BODY**

Body: Mazda Speed 6  
 Wing Height: \_\_\_\_\_  
 Wing Position: \_\_\_\_\_