



# SETUP SHEET



## TRACK CONDITIONS

Type :  Carpet  Asphalt  
 Place :  Indoor  Outdoor  
 Surface :  Smooth  Med.  Bumpy

Size:  Open  Med.  Tight  
 Traction:  High  Med.  Low  
 Track Temp/Air Temp: \_\_\_\_\_ / \_\_\_\_\_ 25  
 Note: \_\_\_\_\_

## FRONT SUSPENSION

Track Width: \_\_\_\_\_ mm  Gear Diff \_\_\_\_\_ wt  
 Toe Angle: \_\_\_\_\_ 0°  Ball Diff  
 Caster: \_\_\_\_\_ 4°  One Way  
 Camber: \_\_\_\_\_ 2°  Solid Axle  
 Ride Height: \_\_\_\_\_ 5 mm Anti-Roll Bar: ∅ \_\_\_\_\_ 1.5 mm  
 Down Stop: \_\_\_\_\_ 5 mm

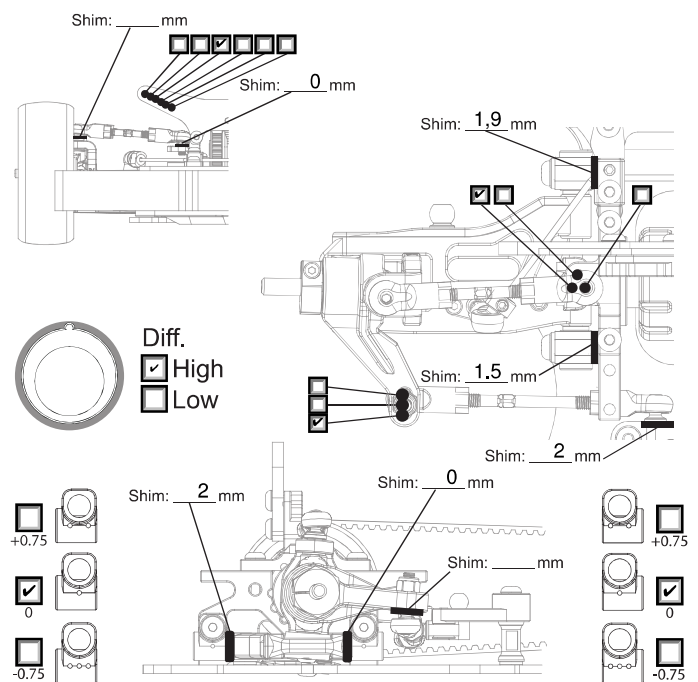

## REAR SUSPENSION

Track Width: \_\_\_\_\_ mm  Gear Diff MR33 D wt  
 Toe Angle: \_\_\_\_\_ 2°  Ball Diff  
 Camber: \_\_\_\_\_ 1°  Solid Axle  
 Ride Height: \_\_\_\_\_ 5 mm  
 Down Stop: \_\_\_\_\_ 6 mm Anti-Roll Bar: ∅ \_\_\_\_\_ 1.4 mm

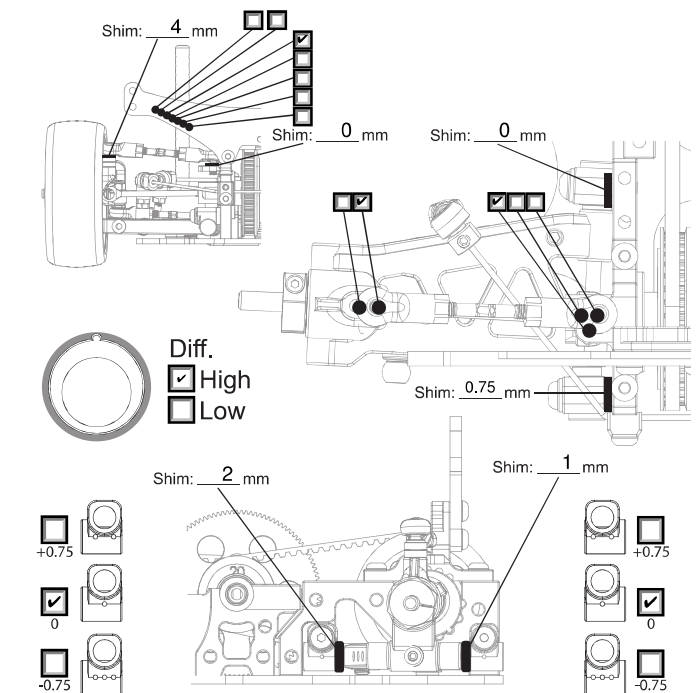

## STIFF SETTING

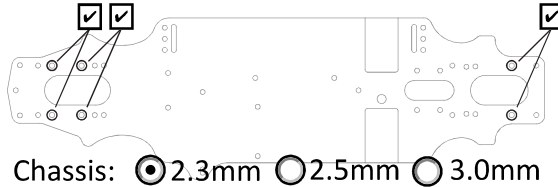
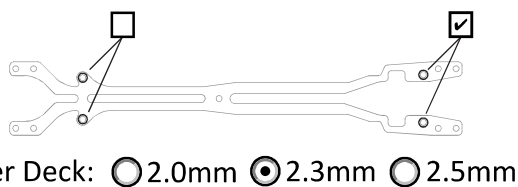

## ELECTRONICS

Servo: Sanwa SRG BL  
 ESC: PRT  
 Battery: Reedy 6500

## DRIVE RATIO

Spur 100 T  
 Pinion 39 T  $\times 1.9 = 4.87$

## MOTOR

Brand: GM/ PRT :)  
 Turns: 10.5  
 Timing: full

## TIRES

Insert: \_\_\_\_\_  
 Wheel: \_\_\_\_\_  
 Shore/deg: Ride 32 carpet  
 Compound: \_\_\_\_\_  
 Tire Temp: \_\_\_\_\_  
 Tire additive: AME/ CS  
 Treated Area

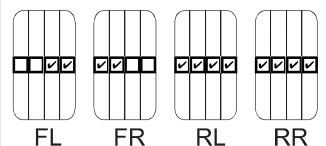

## SHOCKS

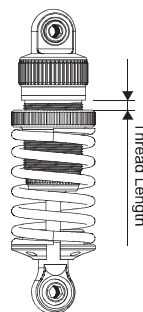

Hole Size: F 1.1/ 1.2 R stock  
 Holes In Piston: F 2 R 2  
 Oil wt: F 400 R 400  
 Springs: F kit R kit  
 Rebound: F 0 R 0  
 Bladder Note: \_\_\_\_\_  
 Thread Length: F \_\_\_\_\_ R \_\_\_\_\_

## ESC

Punch: \_\_\_\_\_  
 Initial Brake: \_\_\_\_\_  
 Drag Brake: \_\_\_\_\_  
 ESC Timing  Turbo Timing

## BODY

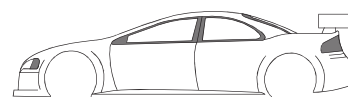

Body: Mazda Speed 6  
 Wing Height: \_\_\_\_\_  
 Wing Position: \_\_\_\_\_