



TRACK CONDITIONS

Type: Carpet Asphalt
 Place: Indoor Outdoor
 Surface: Smooth Med. Bumpy
 Note: _____

Size: Open Med. Tight
 Traction: High Med. Low
 Track Temp/Air Temp: _____ / 25°C

FRONT SUSPENSION

Track Width: _____ mm Gear Diff _____ wt
 Toe Angle: _____ ° Spool
 Caster: _____ ° One Way
 Camber: 1,5 °
 Ride Height: 5,5 mm Anti-Roll Bar: Ø 1,4 mm
 Down Stop: 6 mm

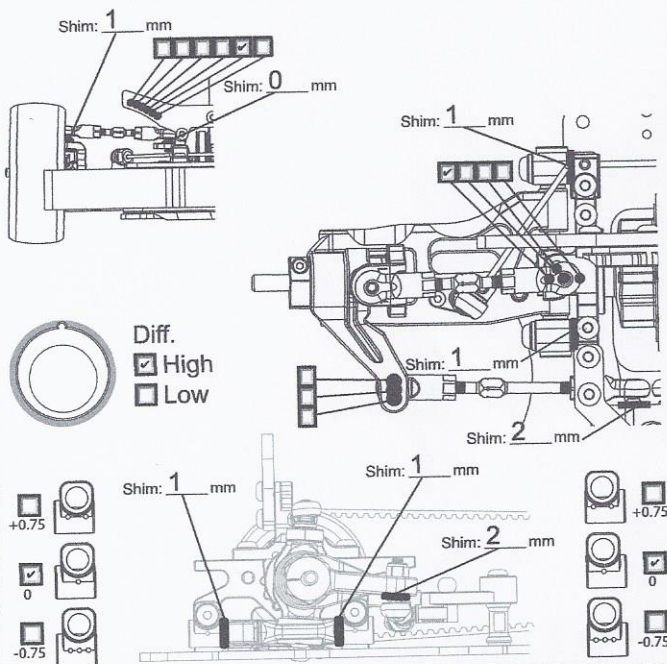

REAR SUSPENSION

Track Width: _____ mm Gear Diff 800 wt
 Toe Angle: _____ °
 Camber: 2 °
 Ride Height: 5,5 mm
 Down Stop: 5 mm Anti-Roll Bar: Ø 1,2 mm

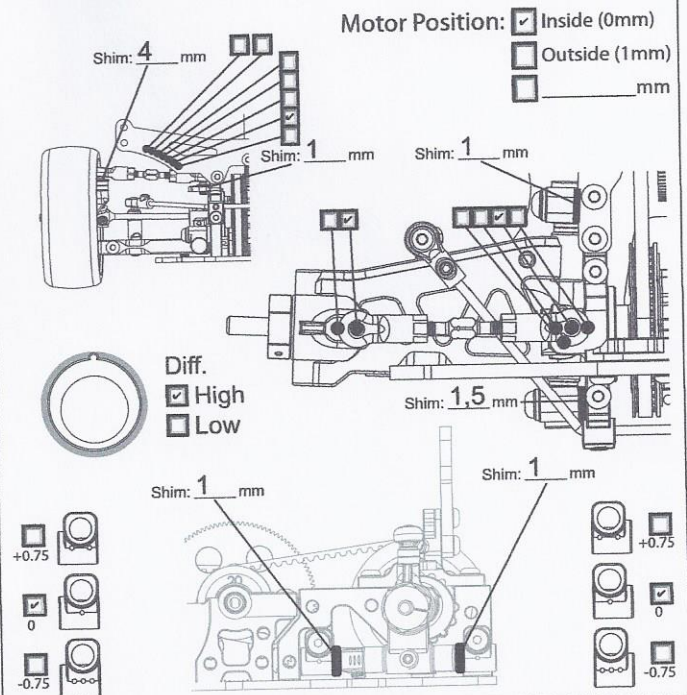

STIFF SETTING

Upper Deck: 2.0mm 2.3mm 2.5mm

Chassis: 2.3mm 2.5mm 3.0mm

ELECTRONICS

Servo: Sanwa SDX 801
 ESC: LRP SPX Zero
 Battery: Boomerang 6000

MOTOR

Brand: LRP X12
 Turns: 13,5
 Timing: Std

ESC

Punch: _____
 Initial Brake: _____
 Drag Brake: _____
 ESC Timing Turbo Timing
 0Boost

DRIVE RATIO

Spur 110 T
 Pinion 39 T $\times 1.9 = 5.36$

TIRES

Insert: Ride
 Wheel: _____
 Shore/deg: _____
 Compound: _____
 Tire Temp: _____
 Tire additive: _____
 Treated Area

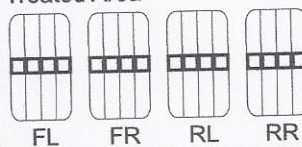

SHOCKS

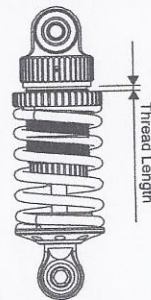

Hole Size: F 1,1 R 1,1
 Holes In Piston: F 3 R 3
 Oil wt: F 350 R 350
 Springs: F HB Silber R HB Silber
 Rebound: F 10% R 10%
 Bladder Note: _____
 Thread Length: F _____ R _____

BODY

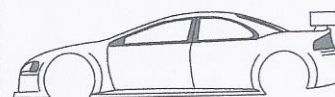

Body: Ferrari 360 Modena
 Wing Height: _____
 Wing Position: _____