

### TRACK CONDITIONS

Type:  Carpet  Asphalt      Size:  Open  Med.  Tight  
 Place:  Indoor  Outdoor      Traction:  High  Med.  Low  
 Surface:  Smooth  Med.  Bumpy      Track Temp/Air Temp: \_\_\_\_\_ / 23  
 Note: \_\_\_\_\_

### FRONT SUSPENSION

Track Width: \_\_\_\_\_ mm  Gear Diff Putty wt  
 Toe Angle: 1.25 °  Solid Axle (Spool)  
 Caster: 4 °  One Way  
 Camber: 2.25 °  
 Ride Height: 5 mm Anti-Roll Bar:  $\varnothing$  1.3 mm  
 Down Stop: 35.25 mm

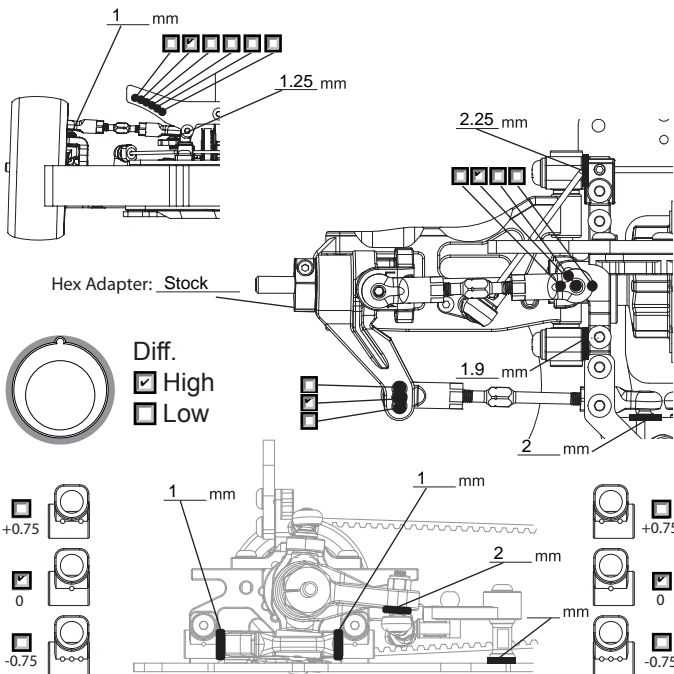

### REAR SUSPENSION

Track Width: \_\_\_\_\_ mm Gear Diff MR33 D wt  
 Toe Angle: 2.5 °  
 Camber: 2.25 °  
 Ride Height: 5 mm  
 Down Stop: 36.25 mm Anti-Roll Bar:  $\varnothing$  1.3 mm

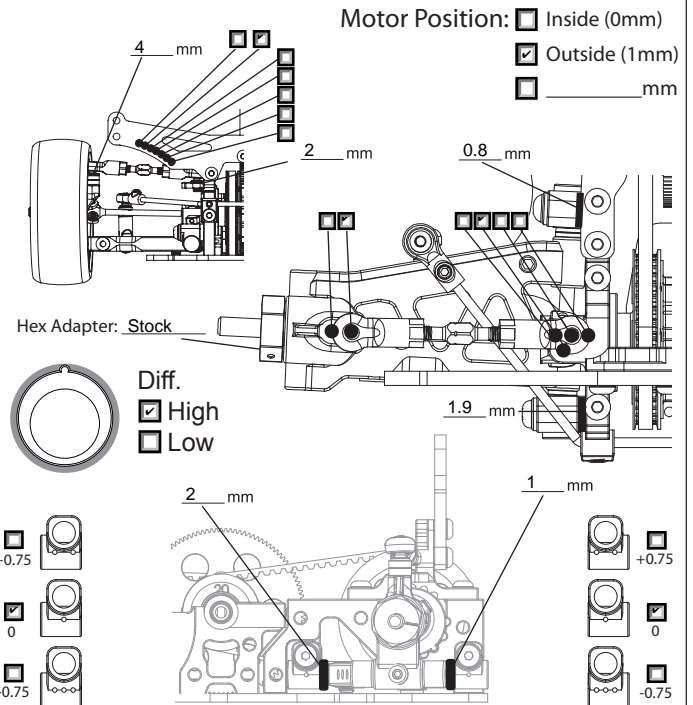

### STIFF SETTING

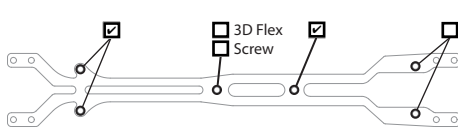

Upper Deck:  2.0mm  2.3mm  2.5mm



Chassis:  2.3mm  2.5mm  3.0mm

### ELECTRONICS

Servo: Sanwa Bls  
 ESC: HW 3.1  
 Battery: IP 7200

### DRIVE RATIO

Spur 110 T  
 Pinion 36 T  $\times 1.9 =$  5.81

### MOTOR

Brand: Thunder Power  
 Turns: 10.5  
 Timing: Full

### TIRES

Insert: Rex30 "vert"  
 Wheel: \_\_\_\_\_  
 Shore/deg: \_\_\_\_\_  
 Compound: \_\_\_\_\_  
 Tire Temp: \_\_\_\_\_  
 Tire additive: CS  
 Treated Area

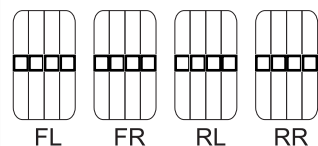

### SHOCKS

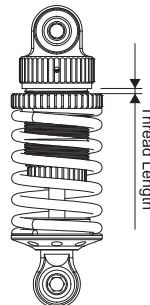

Hole Size: F Stock R Stock  
 Holes In Piston: F 3 R 3  
 Oil wt: F 450 R 450  
 Springs: F Ride violet R Ride rouge  
 Rebound: F \_\_\_\_\_ R \_\_\_\_\_  
 Bladder Note: \_\_\_\_\_  
 Thread Length: F \_\_\_\_\_ R \_\_\_\_\_

### ESC

Punch: \_\_\_\_\_  
 Initial Brake: \_\_\_\_\_  
 Drag Brake: \_\_\_\_\_  
 ESC Timing  Turbo Timing

### BODY

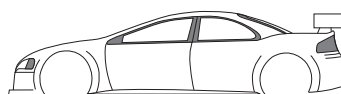

Body: Mazda speed light  
 Wing Height: \_\_\_\_\_  
 Wing Position: \_\_\_\_\_