

E4RS III / III PLUS - Tip 2: Driveshafts assembly

This operation is considered by many users of many RC cars brands as THE hardest step of the assembly.

For sure, the driveshafts are more free with a G-clip, and we never lost a pin during a run since we switched from grub screw to G-clip... but it's less easy to assemble, we can't have all the advantages !

First step is insert the pin end of the G-clip into its hole on the wheel axle.

On second step, you have to push the opposite side of the G-clip on the border of the wheel axle, with the driveshaft.

On step three, you have to use a long nose plier to push the G-clip over the wheel axle.

Job is done on step four, you can install the driveshaft on the car; after lubrication (with copper grease by example).

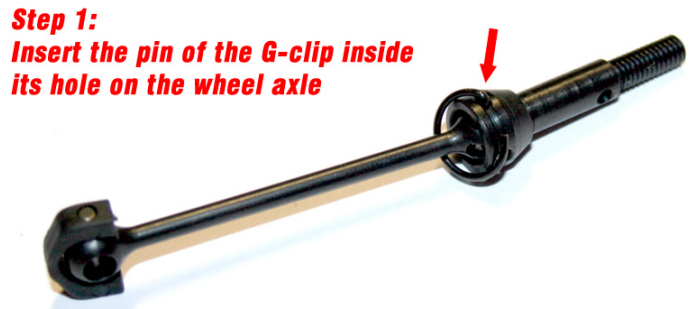

Step 1:
Insert the pin of the G-clip inside its hole on the wheel axle



Step 2:
Push the G-clip on the wheel axle border with the driveshaft

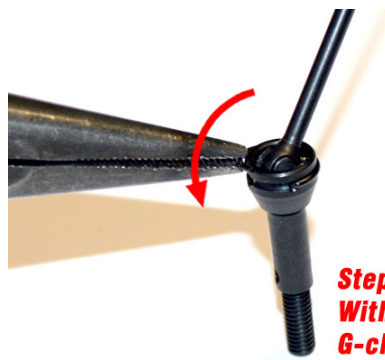

Step 3:
With a long nose plier, push the G-clip's end on the wheel axle

Step 4:
*Job is done !
G-clip well positioned*

